

Soils Map

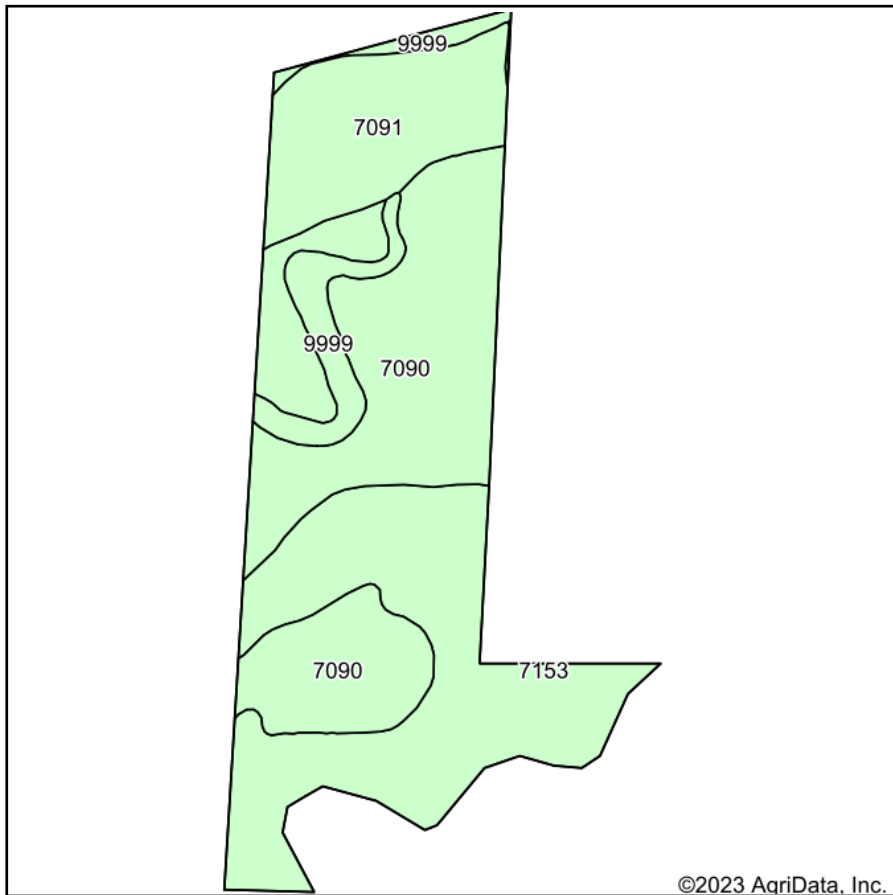

Soils data provided by USDA and NRCS.

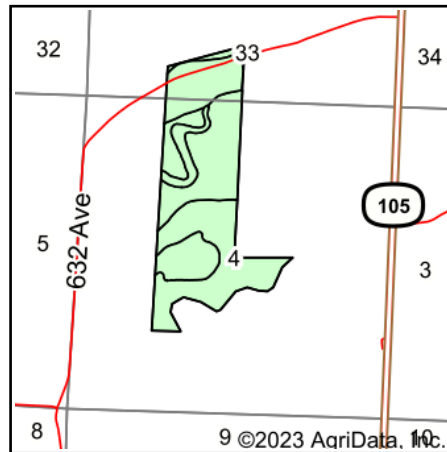

State: **Nebraska**
 County: **Richardson**
 Location: **4-1N-13E**
 Township: **Speiser**
 Acres: **138.19**
 Date: **9/12/2023**

Maps Provided By:

 CUSTOMIZED ONLINE MAPPING
 © AgriData, Inc. 2023 www.AgriDataInc.com



Area Symbol: NE147, Soil Area Version: 21

Code	Soil Description	Acres	Percent of field	Non-Irr Class *c	SRPG	*n NCCPI Soybeans	
7090	Wabash silty clay loam, occasionally flooded	57.81	41.8%		IIIw 51	53	
7153	Kennebec silt loam, rarely flooded	48.93	35.4%		Iw 83	83	
7091	Wabash silty clay, occasionally flooded	22.52	16.3%		IIIw 43	44	
9999	Water	8.93	6.5%		0		
Weighted Average					*-	57.7	*n 58.7

*n: The aggregation method is "Weighted Average using all components"

*c: Using Capabilities Class Dominant Condition Aggregation Method

*- Non Irr Class weighted average cannot be calculated on the current soils data due to missing data.

Soils data provided by USDA and NRCS.