

Soils Map

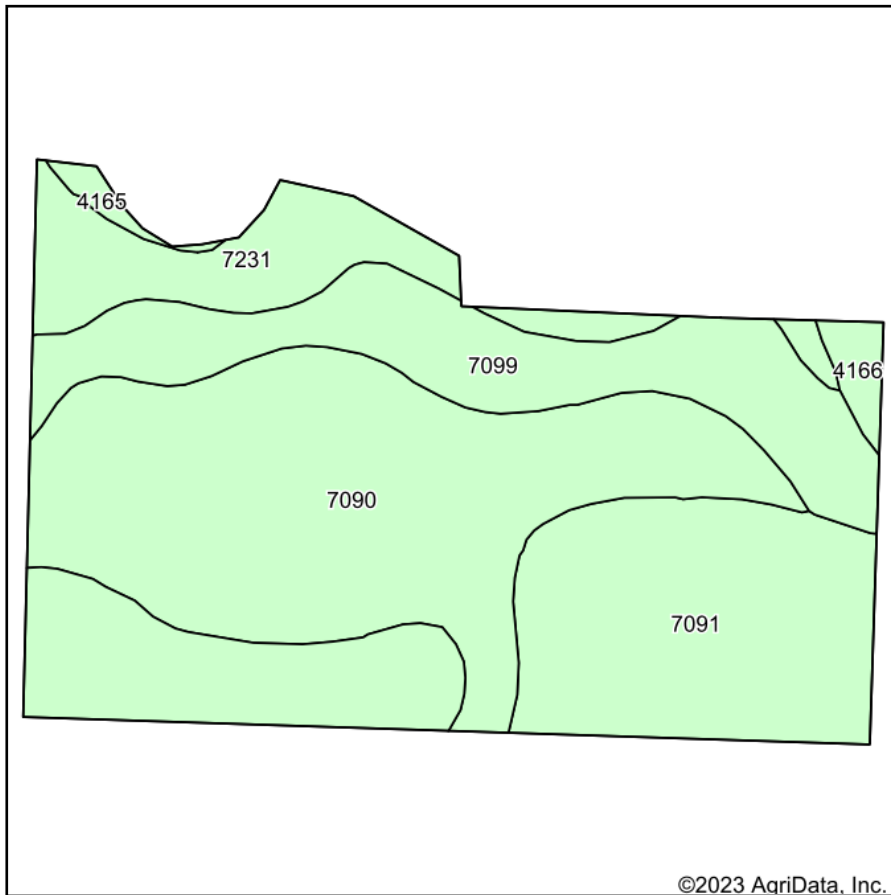

Soils data provided by USDA and NRCS.

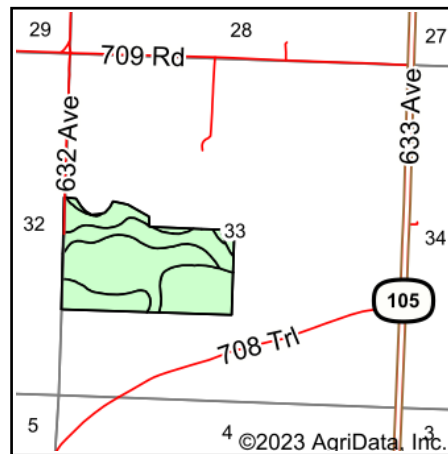

State: **Nebraska**
 County: **Richardson**
 Location: **33-2N-13E**
 Township: **Humboldt**
 Acres: **87.76**
 Date: **9/6/2023**

Maps Provided By:



Area Symbol: NE147, Soil Area Version: 21

Code	Soil Description	Acres	Percent of field	Non-Irr Class *c	Irr Class *c	SRPG	Alfalfa hay Tons	Alfalfa hay Irrigated Tons	Bromegrass alfalfa AUM	Bromegrass alfalfa Irrigated AUM	Corn Bu	Corn Irrigated Bu	Grain sorghum Bu	Grain sorghum Irrigated Bu	Soybeans Bu	Soyl Irrig
7090	Wabash silty clay loam, occasionally flooded	33.06	37.7%	IIIw		51										
7099	Zook silty clay loam, occasionally flooded	25.60	29.2%	IIw	IIw	60	5	6	5	13	94	137	87	120	38	
7091	Wabash silty clay, occasionally flooded	18.11	20.6%	IIIw		43										
7231	Judson silt loam, 2 to 6 percent slopes	9.19	10.5%	IIe		79										
4166	Kipson-Sogn complex, 3 to 30 percent slopes	1.15	1.3%	VI s		5										
4165	Kipson-Benfield silty clay loams, 7 to 17 percent slopes	0.65	0.7%	VIe		22										
Weighted Average				2.67	*-	54.1	1.5	1.8	1.5	3.8	27.4	40	25.4	35	11.1	

*n: The aggregation method is "Weighted Average using all components"

*c: Using Capabilities Class Dominant Condition Aggregation Method

*- Irr Class weighted average cannot be calculated on the current soils data due to missing data.

Soils data provided by USDA and NRCS.