

Soils Map

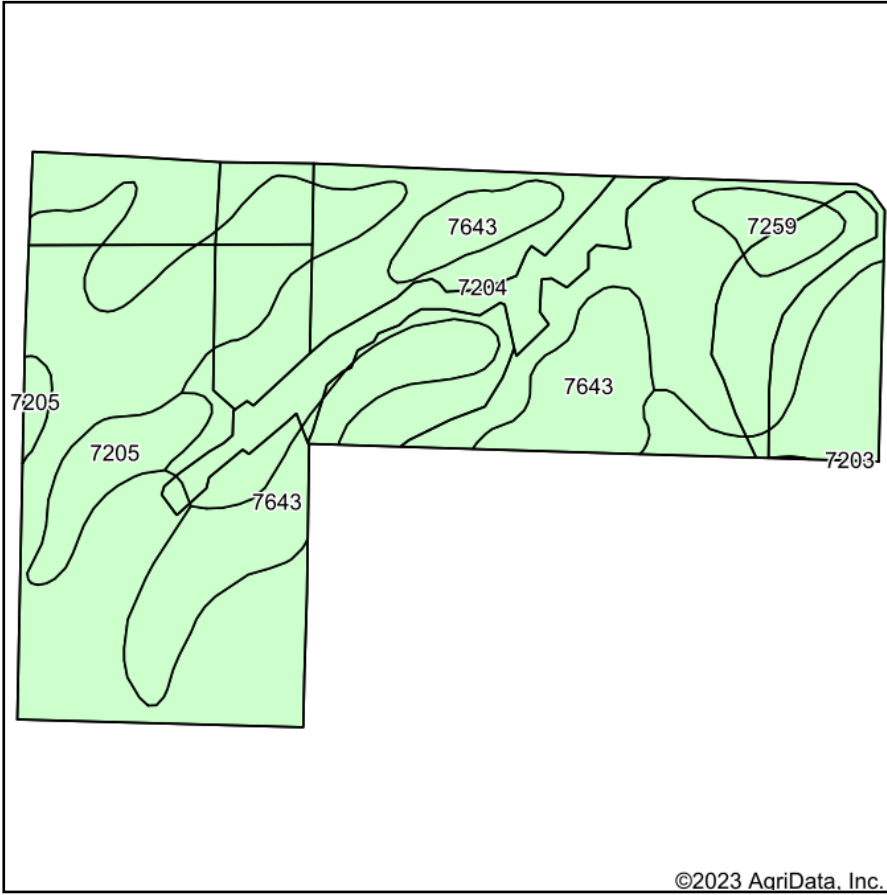

Soils data provided by USDA and NRCS.

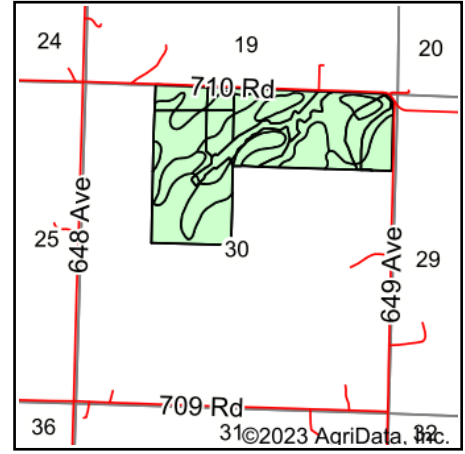

State: **Nebraska**
 County: **Richardson**
 Location: **30-2N-16E**
 Township: **Ohio**
 Acres: **157.24**
 Date: **7/10/2023**

Maps Provided By:



Area Symbol: NE147, Soil Area Version: 21

Code	Soil Description	Acres	Percent of field	Non-Irr Class *c	Irr Class *c	SRPG	Alfalfa hay Tons	Alfalfa hay Irrigated Tons	Corn Bu	Corn Irrigated Bu	Grain sorghum Bu	Grain sorghum Irrigated Bu	Soybeans Bu	Soybeans Irrigated Bu	Winter wheat Bu	*n NCCPI Soybeans
7204	Aksarben silty clay loam, 6 to 11 percent slopes, eroded	63.74	40.5%	IIIe	IVe	67										55
7203	Aksarben silty clay loam, 2 to 6 percent slopes, eroded	55.35	35.2%	IIIe	IIIe	71										53
7643	Yutan silty clay loam, 3 to 11 percent slopes, eroded	27.10	17.2%	IIIe	IVe	68	3	1	85	107	76	12	29	34	31	56
7205	Aksarben silty clay loam, 0 to 2 percent slopes	7.05	4.5%	Iw	Iw	74										60
7259	Deroin silty clay loam, 6 to 11 percent slopes, severely eroded	4.00	2.5%	IVe	IVe	71	4		72		74				28	56
Weighted Average				2.94	3.51	69	0.6	0.2	16.5	18.4	15	2.1	5	5.9	6.1	*n 54.7

*n: The aggregation method is "Weighted Average using all components"

*c: Using Capabilities Class Dominant Condition Aggregation Method

Soils data provided by USDA and NRCS.